

FLEXIBLE, ALL INCLUSIVE OFFICE SUITES
THREE SUITES AVAILABLE
1,423 SQ FT / 2,316 SQ FT / 2,664 SQ FT



*26-28 HAMMERSMITH GROVE

right now*



Fully fitted with all furniture,
power and data cabling



Flexible leases



24/7 Access



On site café



Staff discounts and benefits
via the exclusive Locale APP



Fixed exit costs



Zero capital expenditure



Gym in the basement



Full concierge service



Excellent train links



Generous car parking



Designed by
Thirdway Interiors



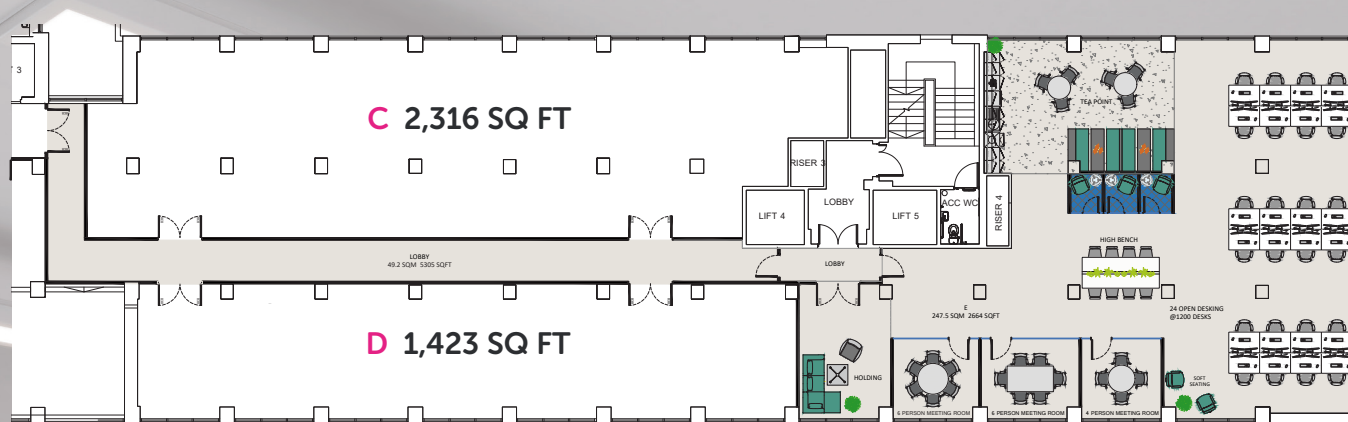

- E 2,664 SQ FT**
- 24** DESKS
 - 03** MEETING ROOMS
 - 01** TEAPOINT
 - 01** BREAKOUT AREA
 - 08** HOT DESKS
 - 03** PHONE BOOTHS



space
planning*

getting around*

*

4

underground
lines

12

miles to
Heathrow
Airport

14

minutes to
the West End

12

minutes to
Paddington

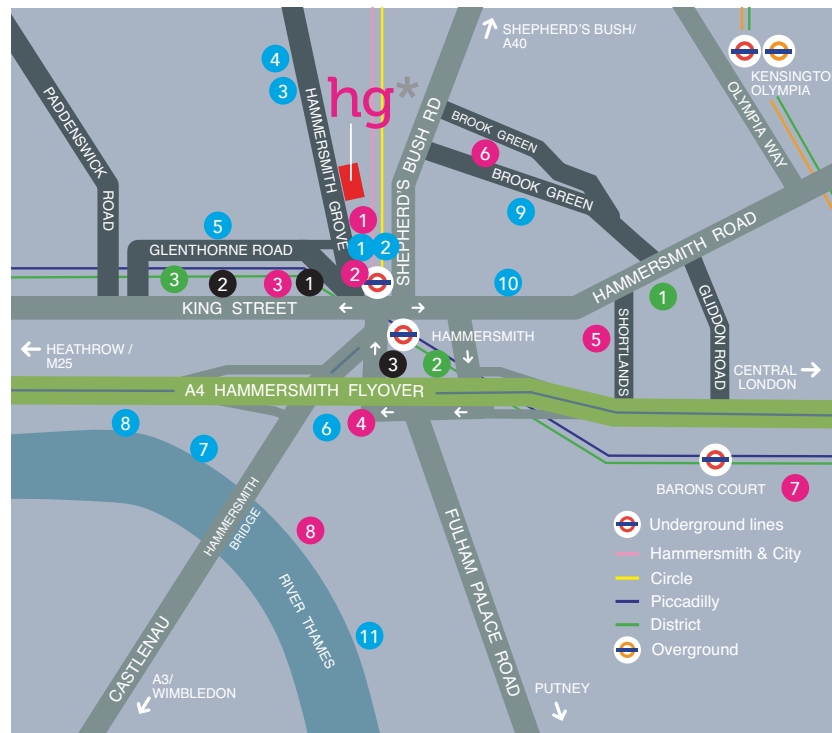

• Shopping

1. **LYRIC SQUARE**
2. **KINGS MALL**
3. **BROADWAY SHOPPING CENTRE**

• Hotels

1. **St. Paul's Hotel**
2. **NOVOTEL**
3. **Holiday Inn**

• Lifestyle / Entertainment

1. **Fitness First**
2. **BOOM! CYCLE**
3. **LYRIC THEATRE**
4. **eventim apollo**
5. **Virgin active**
6. **Brook Green Tennis Club**
7. **RIVERSIDE STUDIOS**

• Restaurants and Pubs

1. **Bill's**
2. **BYRON**
3. **THE GROVE**
4. **Bertotti**
5. **THE STONEMASONS ARMS**
6. **thegate**
7. **RUTLAND ARMS**
8. **THE DOVE**
9. **THE QUEEN'S HEAD**
10. **SUZU**
11. **The River Of**



By Underground

Paddington	12 minutes
Victoria	14 minutes
Green Park	14 minutes
Charing Cross	20 minutes
Waterloo	22 minutes
King's Cross	24 minutes
Heathrow Airport	32 minutes
Liverpool Street	32 minutes

Source: London Underground



By Road

London	5 miles
Heathrow Airport	12 miles
M40 J1a	15 miles
M4 J1	2 miles
M25 J15	12 miles
M3 J1	11 miles

Source: RAC Route Planner

marianne.thomas@cbre.com

ddi: 020 7182 2070

peter.york@cbre.com

ddi: 020 7182 3280

CBRE
020 7182 2000
www.cbre.co.uk

hanovergreen
020 3130 6400
hanovergreen.co.uk

dcuthbert@hanovergreen.co.uk

ddi: 020 3130 6401

rzoers@hanovergreen.co.uk

ddi: 020 3130 6414